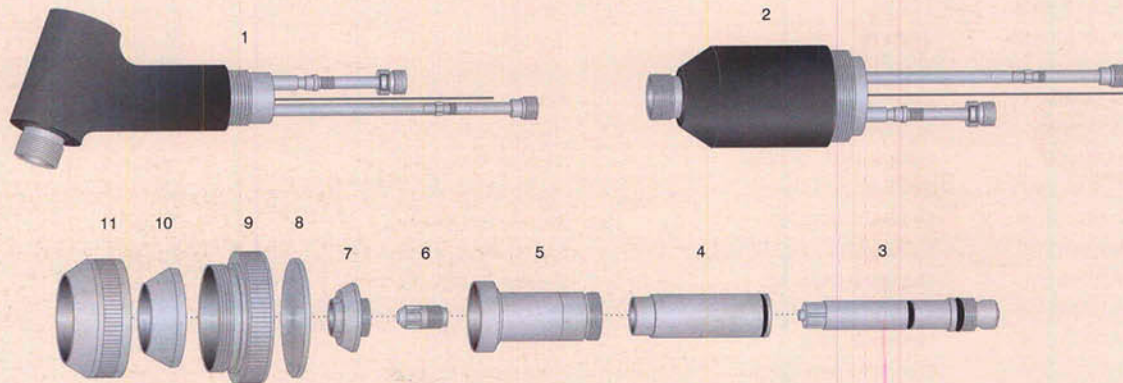

IN ESAURIMENTO

ITEM	Part No	DESCRIPTION	ORIGINAL REF.	PACK
1	PLTD4B.03.P	Ghiera posteriore di bloccaggio - Back cap	8-4158	10
2	PLTD4B.04	Molla - Spring	8-4050	10
3	PLTD4B.05.1	Portaelettrodo Std. - Collet Std.	8-4156	10
4	PLTD4B.05.11	Portaelettrodo (solo per 4BT) - Collet (for 4BT only)	8-4197	10
5	PLTD4B.05.2	Manicotto isolante - Sleeve	8-4182	10
6	PLTD4B.05.3	Diffusore - Liner	8-4154	10
7	PLTD4B.01	Elettrodo - Electrode	8-4073	10
8	PLTD4B.01.2	Ugello Lo-Amp - .030 - Tip Lo-Amp - .030	8-4189	10

 REPLACEMENT PARTS SUITABLE FOR: **THERMAL DYNAMICS® PCH-6B**
 Pak-44, Pak-45

ITEM	Part No	DESCRIPTION	ORIGINAL REF.	PACK
1	PLTD6B.06	Corpo torcia 70° - Torch head 70°	8-6583	
	PLTD6B.06.9	Corpo torcia 90° - Torch head 90°	8-6584	
2	PLTD6B.06.M	Corpo torcia macchina 180° - Machine torch head 180°	8-6577	
3	PLTD6B.051	Porta elettrodo - Electrode holder	8-6615	10
4	PLTD6B.05	Distributore gas - Gas distributor	8-6569	10
5	PLTD6B.05.3	Diffusore - Liner	8-6571	10
6	PLTD6B.01.1	Elettrodo gen purpose - Electrode gen purpose	8-6578	10
6	PLTD6B.01.2	Elettrodo Lo-Amp - Electrode Lo-Amp	8-6586	10
7	PLTD6B.02.1	Ugello 100A - .067 - con O-Rings - Tip 100A - .067 - w/O-Rings	8-6580	10
7	PLTD6B.02.2	Ugello 150A - .076 - con O-Rings - Tip 150A - .076 - w/O-Rings	8-6648	10
7	PLTD6B.02.3	Ugello 200A - .093 - con O-Rings - Tip 200A - .093 - w/O-Rings	8-6575	10
7	PLTD6B.02.4	Ugello 300A - .113 - con O-Rings - Tip 300A - .113 - w/O-Rings	8-6582	10
7	PLTD6B.02.5	Ugello 400A - .125 - con O-Rings - Tip 400A - .125 - w/O-Rings	8-6572	10
8	PLTD6B.03.1	Isolante - Gasket	8-6512	10
9	PLTD6B.03.2	Isolatore esterno - Outer insulator	8-6581	10
10	PLTD6B.03.3	Terminale - End piece	8-6514	10
11	PLTD6B.03.4	Protezione esterna - End cap	8-6515	10