

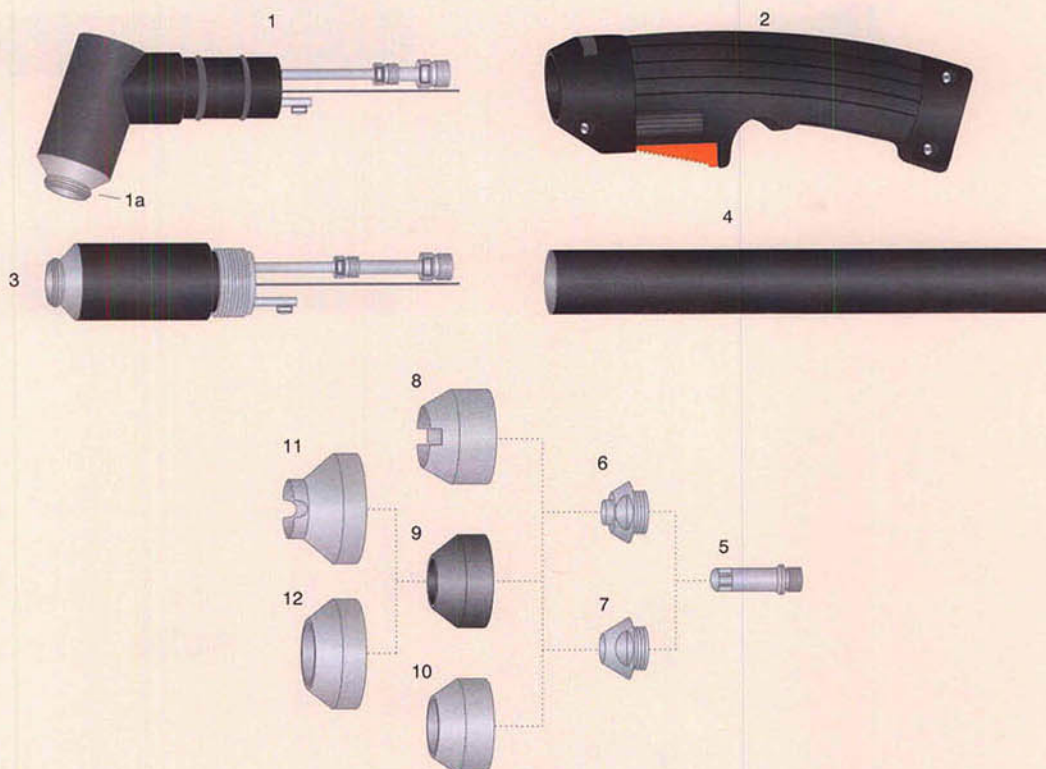

Pak-5XR\*, Pak-7XR, Pak-8XR, Pak-10XR, Pak-625XR\*, Pak-750XR\*, Pak-1000XR, Pak-1250XR (\*=Dual Gas)



ITEM	Part No	DESCRIPTION	ORIGINAL REF.	PACK	
<b>COMPLETE TORCHES</b>	PLTD52.6	<b>Torcia completa mt. 7,5</b>	- Complete torch 7,5 Mts.	2-2936	
	PLTD52.12	<b>Torcia completa mt. 15</b>	- Complete torch 15 Mts.	2-2937	
	PLTD52.6.M	<b>Torcia macchina completa mt. 7,5</b>	- Machine complete torch 7,5 Mts.	2-2938	
	PLTD52.12.M	<b>Torcia macchina completa mt. 15</b>	- Machine complete torch 15 Mts.	2-2939	
1	PLTD52.06	<b>Corpo torcia 70°</b>	- Torch head 70°	9-5642	
1a	PLORING.2	<b>O-Ring</b>	- O-Ring	8-5525	10
2	PLTD52.08	<b>Impugnatura</b>	- Handle	9-5644E	
3	PLTD52.06.M	<b>Corpo torcia macchina 180°</b>	- Machine torch head 180°	9-5643	
4	PLTD52.08.M	<b>Impugnatura macchina</b>	- Machine handle	9-7833	
5	PLTD52.01	<b>Elettrodo long life</b>	- Electrode long life	8-3331	10
5	PLTD52.01.N	<b>Elettrodo long life nichelato</b>	- Electrode - Long life nickel plated	9-5619	10
5	PLTD52.01.M	<b>Elettrodo multi gas</b>	- Electrode multi gas	9-5711	10
6	PLTD52.02.08	<b>Ugello 35A - Ø 0,90 mm. - .035</b>	- Tip 35A - Ø 0,90 mm. - .035	9-5702	10
6	PLTD52.02.11	<b>Ugello 45/55A - Ø 1,10 mm. - .043</b>	- Tip 45/55A - Ø 1,10 mm. - .043	9-5618	10
6	PLTD52.02.12	<b>Ugello 60/70A - Ø 1,20 mm. - .047</b>	- Tip 60/70A - Ø 1,20 mm. - .047	9-5707	10
6	PLTD52.02.13	<b>Ugello 80A - Ø 1,32 mm. - .052</b>	- Tip 80A - Ø 1,32 mm. - .052	9-5782	10
6	PLTD52.02.15	<b>Ugello 105A - Ø 1,50 mm. - .059</b>	- Tip 105A - Ø 1,50 mm. - .059	9-5708	10
7	PLTD52.02.20	<b>Ugello gouging 70A - Ø 1,99 mm. - .078</b>	- Gouging Tip 70A - Ø 1,99 mm. - .078	9-5709	10
7	PLTD52.02.24	<b>Ugello gouging 105A - Ø 2,36 mm. - .093</b>	- Gouging Tip 105A - Ø 2,36 mm. - .093	9-5710	10
7	PLTD52.02.27	<b>Ugello gouging 105A - Ø 2,87 mm. - .113</b>	- Gouging Tip 105A - Ø 2,87 mm. - .113	9-5713	10
8	PLTD52.03.4	<b>Ugello esterno in ceramica a 4 punte</b>	- Crown ceramic outside nozzle	9-5694	10
9	PLTD52.03.F	<b>Ugello esterno in fibra</b>	- Phenolic outside nozzle	9-5781	10
10	PLTD52.03	<b>Ugello esterno in ceramica</b>	- Ceramic outside nozzle	9-5617	10
11	PLTD52.03.MT4	<b>Protezione in metallo a 4 punte per ugello esterno in fibra</b>	- Metal shield cup crown for phenolic outside nozzle	9-5780	10
12	PLTD52.03.MT	<b>Protezione in metallo per ugello esterno in fibra</b>	- Metal shield cup for phenolic outside nozzle	9-5799	10
	PLTD52.20.1	<b>Pacco cavi da mt. 7,5</b>	- Complete cable 7,5 Mts.	4-5034	
	PLTD52.20.2	<b>Pacco cavi da mt. 15</b>	- Complete cable 15 Mts.	4-5035	
	PLTD52.20.M1	<b>Pacco cavi da mt. 7,5 per torcia macchina</b>	- Complete cable 7,5 Mts. machine torch	4-5036	
	PLTD52.20.M2	<b>Pacco cavi da mt. 15 per torcia macchina</b>	- Complete cable 15 Mts. machine torch	4-5037	