

ITEM	Part No	DESCRIPTION	ORIGINAL REF.	PACK	
COMPLETE TORCHES	PLTD40.7	Torcia completa mt. 7,5	- Complete torch 7,5 Mts.	2-5035	
	PLTD40.15	Torcia completa mt. 15	- Complete torch 15 Mts.	2-5036	
	PLTD40.7.M	Torcia completa macchina mt. 7,5	- Machine complete torch 7,5 Mts.	2-5039	
	PLTD40.15.M	Torcia completa macchina mt. 15	- Machine complete torch 15 Mts.	2-5040	
1	PLTD40.06	Corpo torcia	- Torch head	9-8055	
2	PLTD51.08	Impugnatura	- Handle	9-8059	
3	PLTD40.06.M	Corpo torcia macchina 180°	- Machine torch head 180°	9-8053	10
4	PLTD52.08.M	Impugnatura macchina	- Machine handle	9-7833	10
5	PLTD35.01L	Elettrodo Liscio-Hf Long life Ø 4,1	- Electrode - Hf Long life Ø 4,1	9-6506	10
5a	PLTD35.01.LZ	Elettrodo Zigrinato-Hf long life Ø 4,1	- Smooth Electrode - Hf Long life Ø 4,1	9-6506	10
6	PLTD35.05.L	Distributore Gas VESPEL® long life	- Gas distributor VESPEL® - Long life	9-6507	10
7	PLTD35.02.08DL	Ugello Drag cut long life	- Drag cut tip - Long life	9-6501	10
8	PLTD35.02.08SL	Ugello Standoff long life	- Standoff tip - Long life	9-6500	10
8	PLTD40.02.12	Ugello Gouging Ø 1,2 mm.	- Gouging tip Ø 1,2 mm.	9-6502	10
9	PLTD35.03	Ugello esterno	- Outside nozzle	9-6003	10
10	PLTD35.03.4	Protezione esterna per ugello esterno	- Shield cup crown for outside nozzle	9-6004	10
	PLTD40.20.1	Pacco cavi da mt. 7,5	- Complete cable 7,5 Mts.	4-0815	
	PLTD40.20.2	Pacco cavi da mt. 15	- Complete cable 15 Mts.	4-0816	
	PLTD40.20.M1	Pacco cavi da mt. 7,5 per torcia macchina	- Complete cable 7,5 Mts. Machine torch	4-2897	
	PLTD40.20.M2	Pacco cavi da mt. 15 per torcia macchina	- Complete cable 15 Mts. Machine torch	4-2898	

REPLACEMENT PARTS SUITABLE FOR: **THERMAL DYNAMICS® PCH-50**
Pak 5

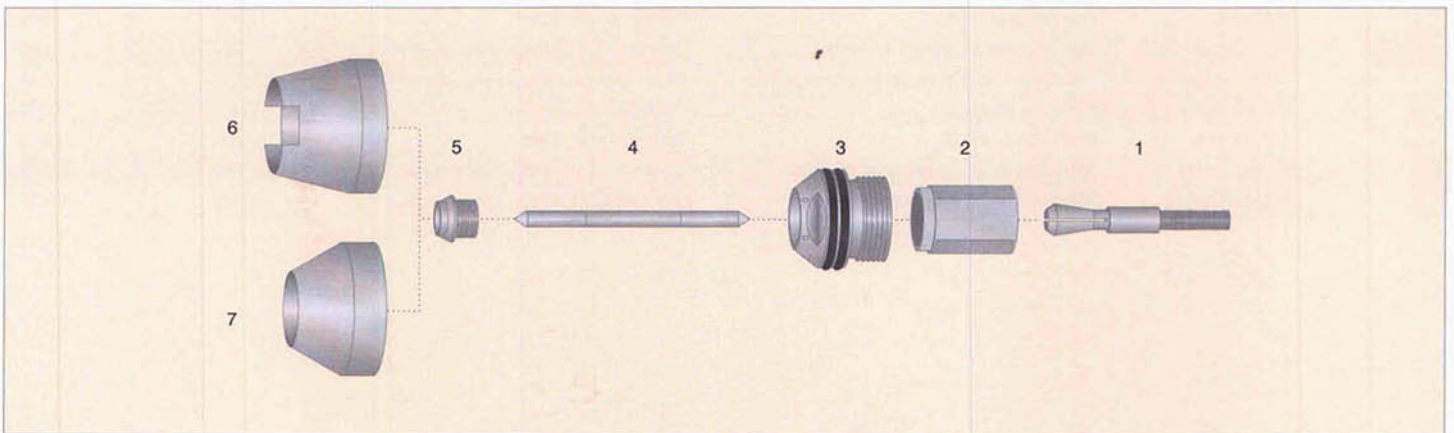

ITEM	Part No	DESCRIPTION	ORIGINAL REF.	PACK	
1	PLTD50.051	Pinza	- Collet	8-5506	10
2	PLTD50.052	Manicotto isolante	- Sleeve	8-5510	10
3	PLTD50.053	Diffusore	- Liner	8-5520	10
4	PLTD50.01	Elettrodo	- Electrode	8-5508	10
5	PLTD50.02	Ugello	- Tip	8-5507	10
6	PLTD50.03.4	Ugello esterno in ceramica a 4 punte	- Crown ceramic outside nozzle	8-5519	10
7	PLTD50.03	Ugello esterno in ceramica	- Ceramic outside nozzle	8-5505	10