

ITEM	Part No	DESCRIPTION	ORIGINAL REF.	PACK	
COMPLETE TORCHES	PLTD26.4	Torcia completa mt. 4	- Complete torch 4 Mts.	2-3501	1
	PLTD26.7	Torcia completa mt. 7.5	- Complete torch 7.5 Mts.	2-3511	1
1	PLTD35.06	Corpo torcia	- Torch head	9-5807	1
2	PLTD51.08	Impugnatura	- Handle	9-6282E	1
3	PLTD35.01L	Elettrodo Liscio-Hf Ø 4,1	- Electrode - Hf Ø 4,1	9-6506	10
3a	PLTD35.01.LZ	Elettrodo Zigrinato-Hf Ø 4,1	- Smooth Electrode - Hf Ø 4,1	9-6506	10
4	PLTD35.05.L	Distributore Gas VESPEL® long life	- Gas distributor VESPEL® - Long life	9-6507	10
5	PLTD35.02.08DL	Ugello Drug cut long life	- Drug cut tip - Long life	9-6501	10
6	PLTD35.03	Ugello esterno	- Outside nozzle	9-6003	10
	PLTD26.20.1	Pacco cavi da mt. 4	- Complete cable 4 Mts.	9-6071	
	PLTD26.20.2	Pacco cavi da mt. 7,5	- Complete cable 7,5 Mts.	9-6072	

REPLACEMENT PARTS SUITABLE FOR: **THERMAL DYNAMICS® PCH/M 28**
Pak Master 50XL

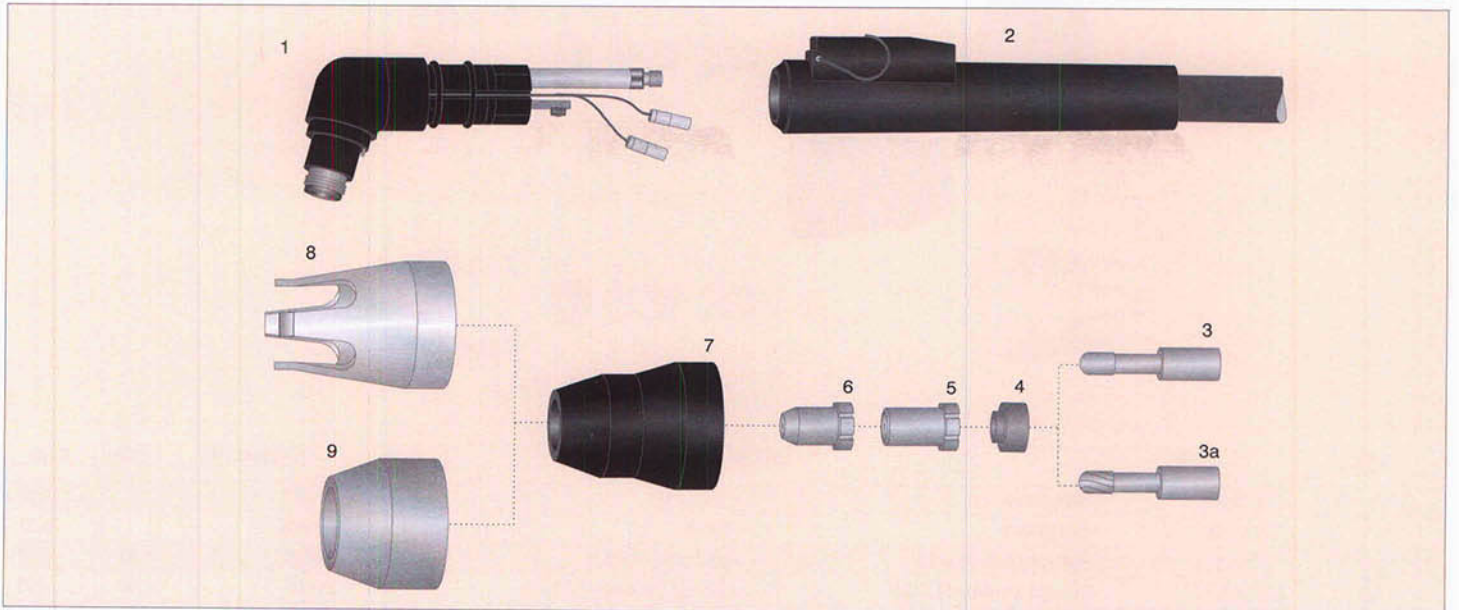

ITEM	Part No	DESCRIPTION	ORIGINAL REF.	PACK	
COMPLETE TORCHES	PLTD28.4	Torcia completa mt. 7.5	- Complete torch 7.5 Mts.	2-5801	1
	PLTD28.7	Torcia completa mt. 15	- Complete torch 15 Mts.	2-5802	1
1	PLTD35.06	Corpo torcia	- Torch head	9-5807	1
2	PLTD51.08	Impugnatura	- Handle	9-6291E	1
3	PLTD35.01L	Elettrodo Liscio-Hf Ø 4,1	- Electrode - Hf Ø 4,1	9-6506	10
3a	PLTD35.01.LZ	Elettrodo Zigrinato-Hf Ø 4,1	- Smooth Electrode - Hf Ø 4,1	9-6506	10
4	PLTD35.05.L	Distributore Gas VESPEL® long life	- Gas distributor VESPEL® - Long life	9-6507	10
5	PLTD35.02.08SL	Ugello standoff long life	- Standoff tip - Long life	9-6500	10
6	PLTD35.02.08DL	Ugello Drag cut long life	- Drag cut tip - Long life	9-6501	10
7	PLTD35.03	Ugello esterno	- Outside nozzle	9-6003	10
8	PLTD35.03.4	Protezione a corona per ugello esterno	- Shield cup crown for outside nozzle	9-6004	10
9	PLTD35.03L	Protezione ugello esterno	- Shield cup for outside nozzle	9-6503	10
	PLTD28.20.1	Pacco cavi da mt. 7.5	- Complete cable 7.5 Mts.	4-2995	
	PLTD28.20.2	Pacco cavi da mt. 15	- Complete cable 15 Mts.	4-2996	