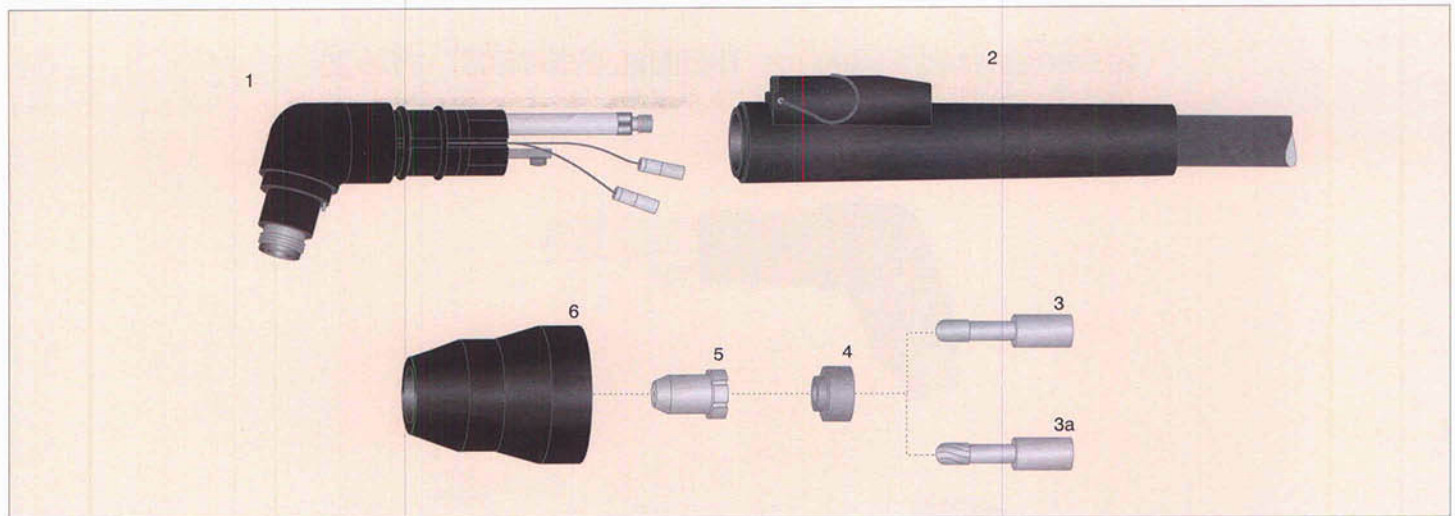

ITEM	Part No	DESCRIPTION	ORIGINAL REF.	PACK	
COMPLETE TORCHES	PLTD25.4	Torcia completa mt. 4	- Complete torch 4 Mts.	2-0250	1
	PLTD25.7	Torcia completa mt. 7,5	- Complete torch 7,5 Mts.	2-0251	1
1	PLTD35.06	Corpo torcia	- Torch head	9-5807	1
2	PLTD51.08	Impugnatura	- Handle	9-6282E	1
3	PLTD35.01	Elettrodo Liscio-Hf Ø 3,5	- Electrode - Hf Ø 3,5	9-6006	10
3a	PLTD35.01.Z	Elettrodo Zigrinato-Hf Ø 3,5	- Smooth Electrode - Hf Ø 3,5	9-6006	10
4	PLTD35.05	Distributore Gas VESPEL®	- Gas distributor - VESPEL®	9-6007	10
5	PLTD25.02	Ugello	- Tip	9-4476	10
6	PLTD35.03	Ugello esterno	- Outside nozzle	9-6003	10
	PLTD25.20.1	Pacco cavi da mt. 4	- Complete cable 4 Mts.	4-6067	
	PLTD25.20.2	Pacco cavi da mt. 7,5	- Complete cable 7,5 Mts.	4-6068	

 REPLACEMENT PARTS SUITABLE FOR: **THERMAL DYNAMICS® PCH-25/38**
 Pak Master 38XL, Drag-Gun 38

ITEM	Part No	DESCRIPTION	ORIGINAL REF.	PACK	
COMPLETE TORCHES	PLTD38.4	Torcia completa mt. 4	- Complete torch 4 Mts.	2-3080	1
	PLTD38.7	Torcia completa mt. 7,5	- Complete torch 7,5 Mts.	2-0381	1
1	PLTD35.06	Corpo torcia	- Torch head	9-5807	1
2	PLTD51.08	Impugnatura	- Handle	9-6282E	1
3	PLTD35.01L	Elettrodo Liscio-Hf Ø 4,1	- Electrode - Hf Ø 4,1	9-6506	10
3a	PLTD35.01.LZ	Elettrodo Zigrinato-Hf Ø 4,1	- Smooth Electrode - Hf Ø 4,1	9-6506	10
4	PLTD35.05.L	Distributore Gas VESPEL® long life	- Gas distributor VESPEL® - Long life	9-6507	10
5	PLTD35.02.08DL	Ugello drag cut long life	- Drag cut tip - Long life	9-6501	10
6	PLTD35.03	Ugello esterno	- Outside nozzle	9-6003	10
	PLTD25.20.1	Pacco cavi da mt. 4	- Complete cable 4 Mts.	4-6067	
	PLTD25.20.2	Pacco cavi da mt. 7,5	- Complete cable 7,5 Mts.	4-6068	